

Issue:  
2/18/11 FOR BIDDING

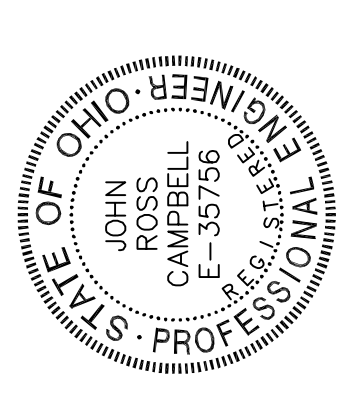

cityarchitectur  
3634 Euclid Avenue  
Suite 100  
Cleveland, Ohio 44115  
Phone: 216.881.2444  
Fax: 216.881.0713  
www.cityarch.com

Project No. 09034  
Drawn By: JRC  
Checked By: JRC

Sheet Number:

DE-1  
2

Copyright © 2009

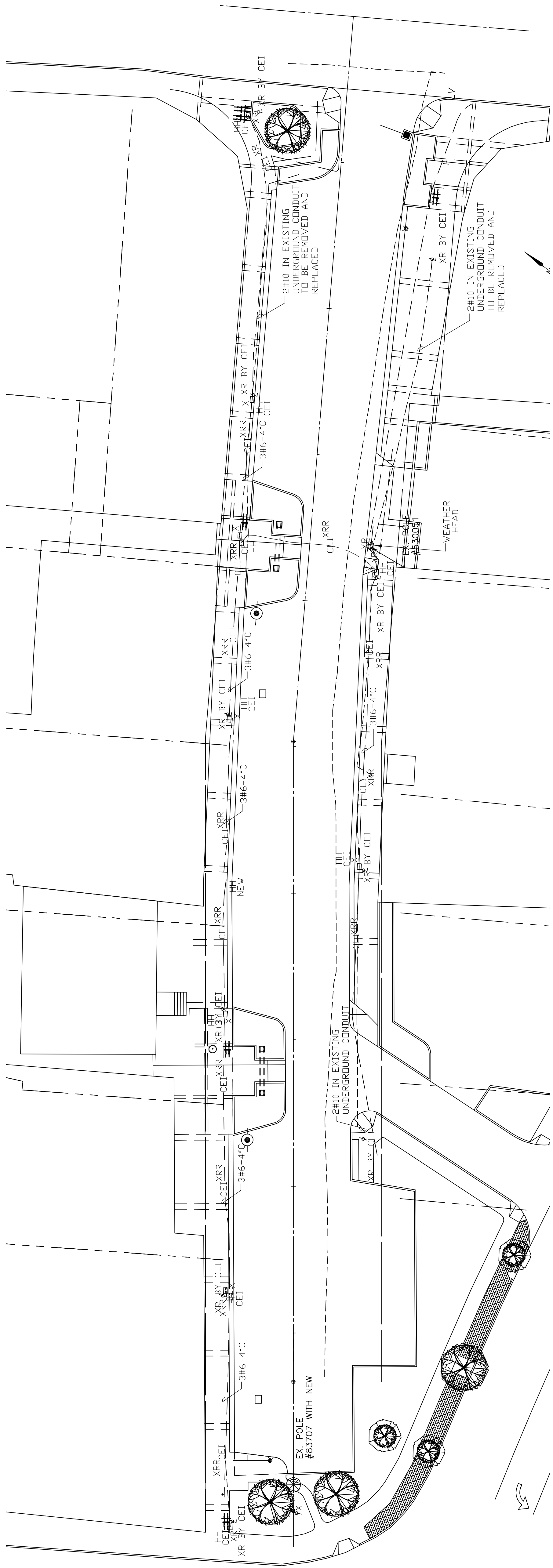

OLD DETROIT ROAD STREETSCAPE LIGHTING DEMOLITION

SCALE: 1" = 20'-0"

ELECTRICAL SPECIFICATIONS

1. THE ELECTRICAL CONTRACTOR SHALL ADVANT HIMSELF WITH THE CONSTRUCTION DETAILS OF THE JOB PRIOR TO SUBMITTING HIS BID.
2. THE ELECTRICAL CONTRACTOR SHALL VISIT THE JOBSITE AND FAMILIARIZE HIMSELF WITH THE ELECTRICAL SERVICE LOCATIONS.
3. THE ELECTRICAL CONTRACTOR SHALL SECURE AND PAY FOR ALL PERMITS PERTAINING TO THE ELECTRICAL WORK.
4. ALL WORK SHALL COMPLY WITH THESE DRAWINGS AND ALL APPLICABLE CODES AND ORDINANCES. ALL WORK SHALL BE INSTALLED PER THE 2009 NEC.
5. ALL ARTICLES, MATERIALS AND EQUIPMENT SHALL BE NEW AND FREE FROM DEFECTS. ALL MATERIALS, WHEN REQUIRED, SHALL BE UL APPROVED.
6. THIS CONTRACTOR SHALL TAKE PRECAUTIONS FOR THE SAFETY OF HIS EMPLOYEES AND THE PUBLIC. ALL WORK SHALL BE CONFINED TO THE WORK AREA AND SHALL MAINTAIN ALL OBSTACLES TO PROTECT HIMSELF, THE OTHER TRADES AND OTHER TRADES FOR THE DURATION OF THE JOB.
7. THE WORK UNDER THIS CONTRACT SHALL BE COORDINATED WITH OTHER TRADES.
8. ALL WIRING SHALL BE RUN IN SCHEDULE 40 PVC CONDUIT BELOW GRADE.
9. ALL WIRING SHALL BE THIN OR THIN #2 AWG COPPER MINIMUM THIN IN DAMP AND WET LOCATIONS.
10. ALL MATERIALS AND WORKMANSHIP SHALL BE GUARANTEED FOR A PERIOD OF ONE YEAR AFTER THE ACCEPTANCE OF THE JOB.
11. THE ELECTRICAL CONTRACTOR SHALL PROVIDE CONDUIT AND POWER WIRING TO THE MECHANICAL EQUIPMENT, CONTROL CONDUITS AND WIRING IN THEIR IS THE RESPONSIBILITY OF THE MECHANICAL CONTRACTOR UNLESS SPECIFICALLY SHOWN ON THE DRAWINGS.
12. THE ENTIRE ELECTRICAL SYSTEM SHALL BE GROUNDED PER THE 2009 NEC.
13. ALL ELECTRICAL EQUIPMENT AND MATERIAL INCLUDING COMPONENTS, SHALL BE UL LABELED AND LISTED PER NEC 110-3(A)(1).
14. ALL CONDUIT PENETRATIONS OF FIRE RATED FLOORS AND WALLS SHALL BE SEALED PER NEC 300-21.
15. RACEWAYS PASSING FROM THE INTERIOR TO THE EXTERIOR OF THE BUILDING SHALL BE FILLED WITH AN APPROVED MATERIAL TO PREVENT THE CIRCULATION OF WARM AIR TO A COLDER SECTION OF THE RACEWAY. NEC 300(T)(A).

ELECTRICAL DEMO LEGEND

SYMBOL	DESCRIPTION
--- CEI*RR	INDICATES EXISTING CONDUIT AND WIRE FOR EXISTING WIRING. THIS SYMBOL IS USED TO INDICATE CONDUIT IS APPROXIMATELY 3 FOOT BELOW GRADE AND ANY CONDUIT THAT IS DAMAGED OR UNUSABLE SHALL BE REPLACED WITH LIKE KIND.
X	INDICATES EXISTING ILLUMINATING COMPANY STREETLIGHT TO BE REMOVED BY THE ILLUMINATING COMPANY-SEE DETAIL
X	INDICATES EXISTING IN-GROUND PULLBOX TO REMAIN- REMOVED CONDUIT AND REPLACE WIRING COMPLETE
X	INDICATES EXISTING ILLUMINATING COMPANY POWER POLE TO REMAIN

NOTES

1. SUBSCRIPTS TO SYMBOLS DENOTE AS FOLLOWS:  
 \*X\* EXISTING TO REMAIN-RECONNECT AS INDICATED.  
 \*XR\* EXISTING TO BE REMOVED INCLUDING CONDUIT AND WIRE BACK TO SOURCE.  
 \*XRR\* EXISTING TO BE REMOVED AND RECONNECTED AS SHOWN.

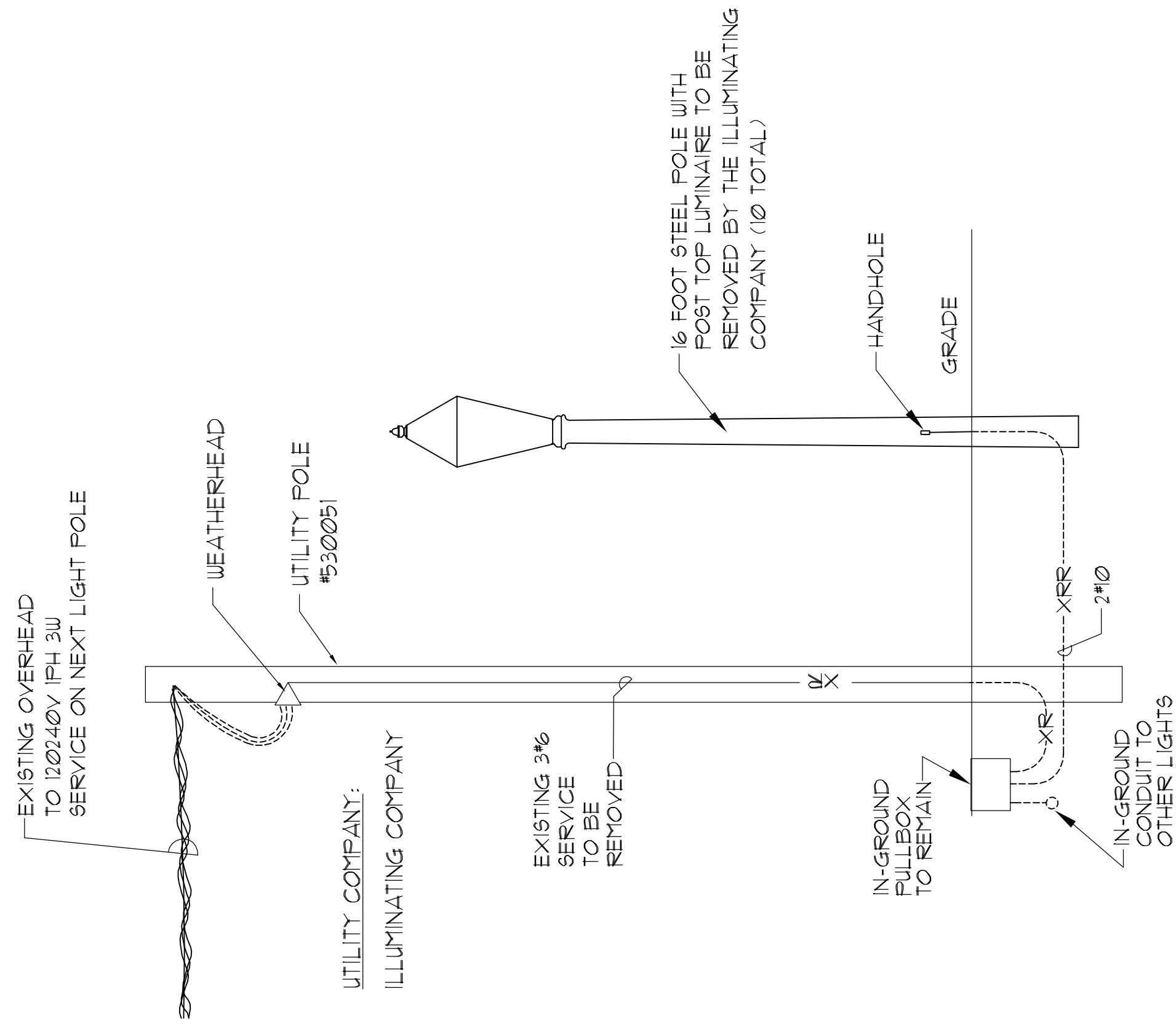

SERVICE DEMOLITION DETAIL

NO SCALE